

# Installation Instructions

## CUSTOM QUICK INSTALL MOUNTING KIT

### Ford Super Duty F-250/F-350/F-450, 1999 & UP

**Part Numbers:**  
**50082**

**Equipment Required:**

Fastener Kit: 50060F

Wrenches: 3/4, 7/8, 15/16, 15 mm

Drill Bits: 1/8", 1/2"

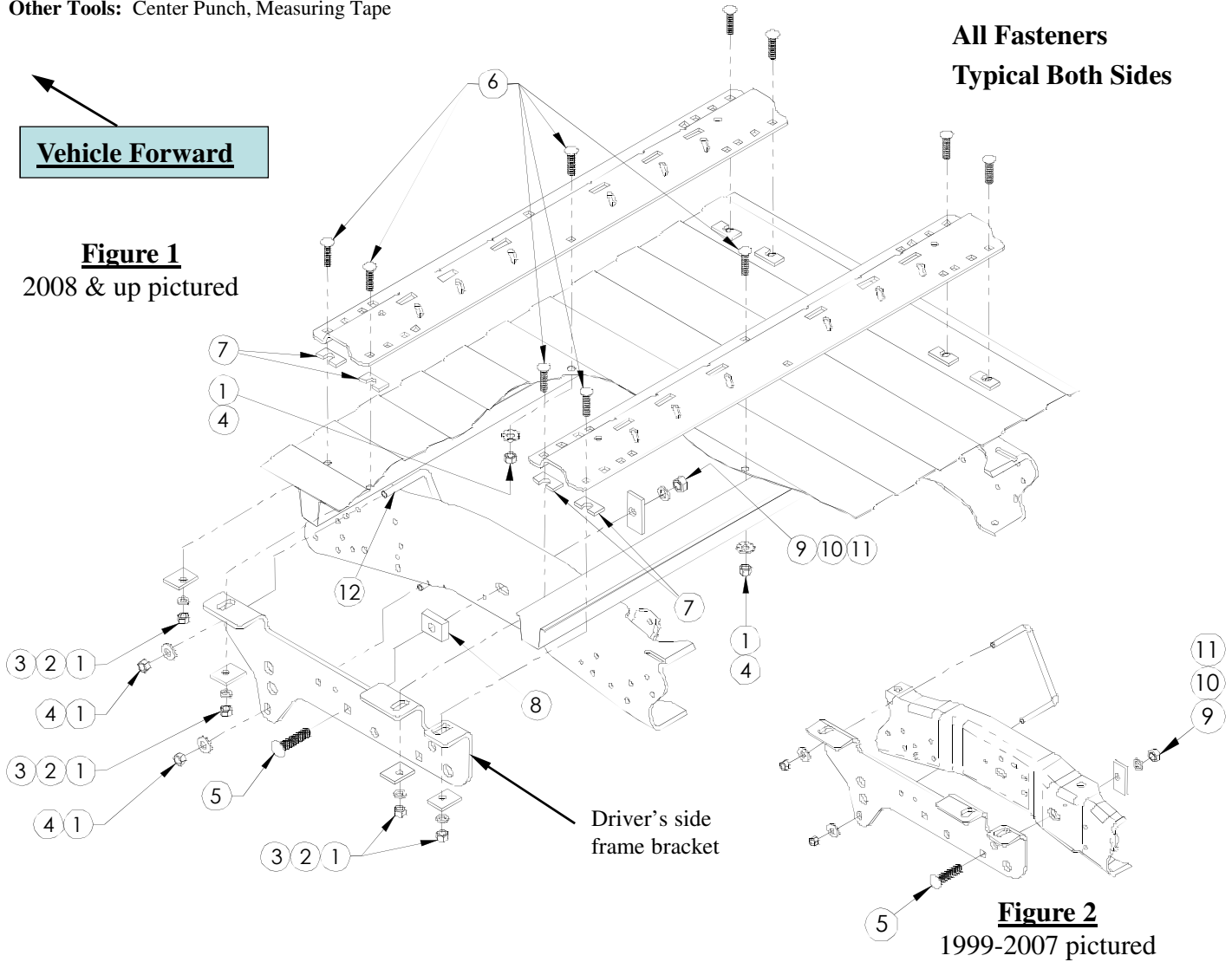
Other Tools: Center Punch, Measuring Tape

**WARNING:** Under no circumstances do we recommend exceeding the towing vehicle manufacturers recommended vehicle towing capacity.

**All Fasteners  
Typical Both Sides**

**Vehicle Forward**

**Figure 1**  
2008 & up pictured



**Figure 2**  
1999-2007 pictured

<b>1</b>	Qty. (14)	Hex Nut, 1/2"	<b>9</b>	Qty. (2)	Hex Nut, 5/8"
<b>2</b>	Qty. (8)	Lock Washer, 1/2"	<b>10</b>	Qty. (2)	Lock Washer, 5/8"
<b>3</b>	Qty. (8)	Spacer, 1/4" x 1-1/2" x 2"	<b>11</b>	Qty. (2)	Spacer, 1/4" x 1-1/2" x 3"
<b>4</b>	Qty. (6)	Conical Washer, 1/2"	<b>12</b>	Qty. (2)	U-Bolt, 1/2"
<b>5</b>	Qty. (2)	Carriage Bolt, 5/8"-11 x 2-1/2", GR8	<b>13</b>	Qty. (1)	Hex Bolt, 1/4"-20 x 1-1/4"
<b>6</b>	Qty. (10)	Carriage Bolt, 1/2"-13 x 2", GR5	<b>14</b>	Qty. (2)	Flat Washer, 1/4"
<b>7</b>	Qty. (8)	U-Shape Block	<b>15</b>	Qty. (1)	Nylok Nut, 1/4"
<b>8</b>	Qty. (2)	Spacer, 5/8" x 1-1/2" x 2-1/8"			

# Installation Instructions

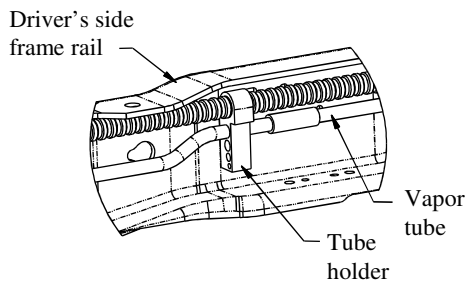
## CUSTOM QUICK INSTALL MOUNTING KIT

Ford Super Duty F-250/F-350/F-450, 1999 & UP

Part Numbers:

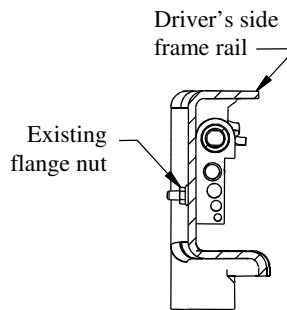
50082

- Do not install mounting rails over plastic bed liners. Plastic bed liners must be cut out of the way to provide metal to metal contact. Mounting rails may be installed on spray in liners.
- Use only bolts, nuts, and washers supplied to install this kit. All bolts are grade 5 and nuts are grade 5 unless otherwise specified.
- These instructions are guidelines only, actual installation is the responsibility of the installer and the owner. Always measure truck and trailer before installing hitch to be sure that there is clearance at the cab and at the bumper to allow for turns.

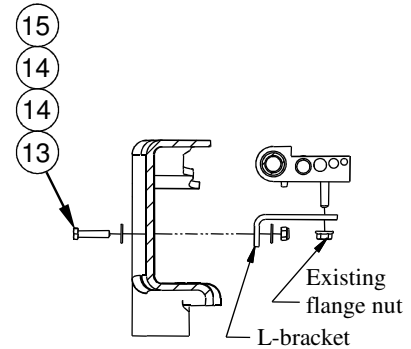


**Figure 3a**

Inside of frame rail



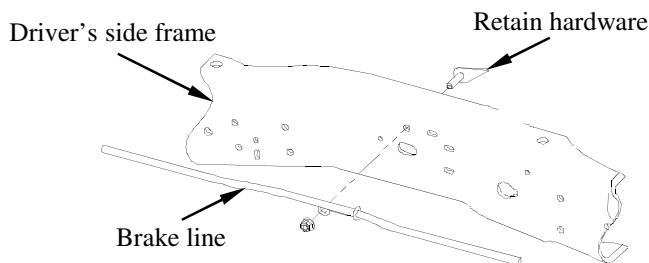
**Figure 3b**



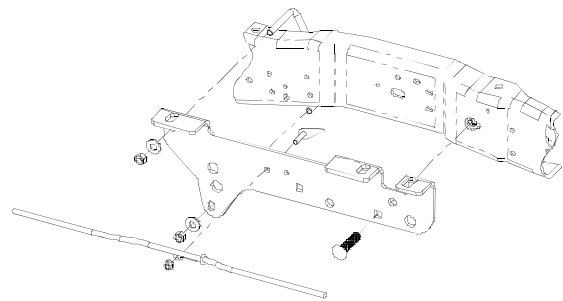
**Figure 3c**

### Installation Instructions

1. Lower and remove spare tire.
2. **On 2005 and up Gas Engine Vehicles Only.** The vapor tube running along the inside of the driver's side frame rail must be relocated prior to installing the driver's side bracket. See Figure 3a. Remove the flange nut from the outside of the frame and keep for later use. See Figure 3b. Rotate the tubes up and out of the way. Install the L-bracket with 1/4" hardware, as shown in Figure 2c. Tighten the L-bracket to the frame, but leave the tube holder loose to aid bracket installation.
3. **On 1999 To 2004 Vehicles Only.** Remove the upper emergency brake cable hanger from the frame of the truck and keep the hardware. See Figure 4a.



**Figure 4a**



**Figure 4b**

4. Place the front mounting rail in the box of the truck. Using your tape measure, center the rail between the weld seams on the length of the truck box floor and the proper distance from the rear edge of the truck box as illustrated in Figure 5 or Figure 6. If using the Pro Series 30124 or 30095 rail kit see Figure 6. See page 6 for mounting the brackets to the rails. See below for mounting the brackets to the frame.
5. Mark and center punch the holes as per the illustration in Figure 5 or Figure 6 if using the Pro Series. Move the rail out of the way and drill each position with a 1/8" drill bit. **Warning: When drilling holes be aware of potential risks to vehicle components and make appropriate safe guards to protect them from damage.**
6. Temporarily position the frame brackets on the outside of the frame and check that the 1/8" drilled holes align with the slots of the frame bracket. Remove the frame bracket from the vehicle.
7. Enlarge the 1/8" drilled holes to 9/16" with the step drill, 5/8" if using Pro Series 30124 rail kit. **Warning: When drilling holes be aware of potential risks to vehicle components and make appropriate safe guards to protect them from damage.**

# Installation Instructions

## CUSTOM QUICK INSTALL MOUNTING KIT

**Ford Super Duty F-250/F-350/F-450, 1999 & UP**

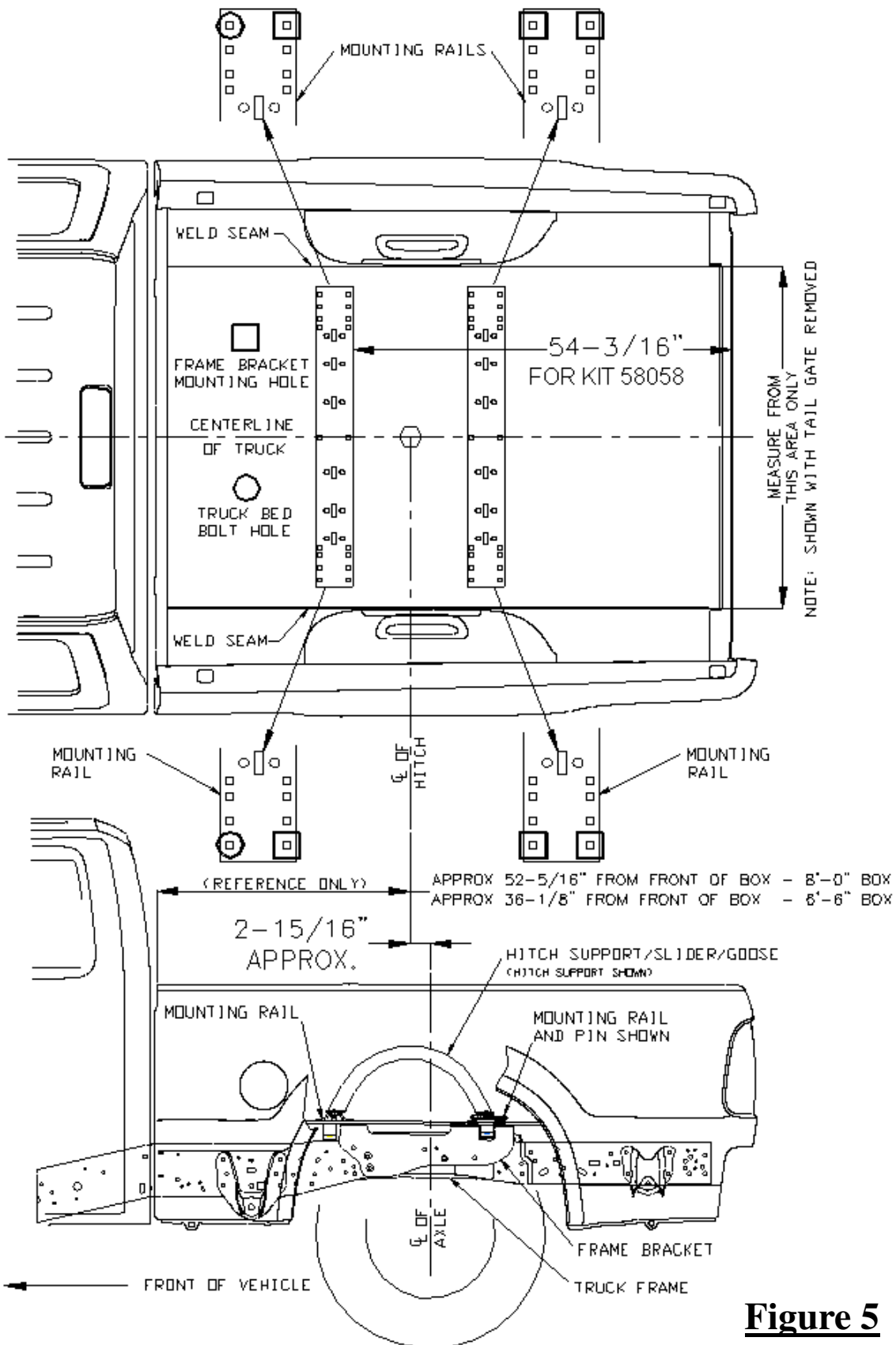
**Part Numbers:**

**50082**

8. **Loosely install the frame brackets as follows:**
  - a. **For 1999 - 2004 vehicles:** Use the hardware removed in Step 3 to attach the upper brake cable to the frame bracket as shown in Figure 4b.
  - b. Position the frame brackets so that the two rear attachment tabs on the bracket are on either side of the rear bed support, as shown in Figure 1.
  - c. Attach the bracket to the frame of the vehicle with the 1/2" u-bolts nuts, and conical washers as shown in Figure 1. Hand tighten the nuts only.
  - d. **For 2008 and up trucks:** Use the slot in the frame that is over the axle to attach the frame bracket with the 5/8" carriage bolt. Make sure to use a 5/8" spacer between the bracket and frame. See Figure 1. Attach the 5/8" bolt to the inside of the frame with 1/4" x 1-1/2" x 3" spacer, lock washer and hex nut. Finger tighten only.
  - e. **For 1999-2007 trucks:** Use the slot in the frame that is under the rear bed support to attach the frame bracket with the 5/8" carriage bolt. The 5/8" spacer **should not be used** between the bracket and frame. See Figure 2. Attach the 5/8" bolt to the inside of the frame with 1/4" x 1-1/2" x 3" spacer, lock washer and hex nut. Finger tighten only.
9. Reposition the mounting rail over the holes. Refer to Fig. 6 if using the Pro Series rail kit 30124, otherwise continue below.
10. Install the 1/2" x 2" long carriage bolts with the U-shaped spacer to be located in the corrugation between the box and the rails. **Note:** The U-shaped spacer will have to be installed before inserting the 1/2" carriage bolts through the mounting rail and box floor. This insures a metal to metal contact. A U-shaped spacer is not needed for the attachment at the center of the rail. Attach the carriage bolts on the ends of the rails with spacers, lock washers, and nuts as per the Figure 1 and tighten snug to keep the mounting rail from moving. Attach the carriage bolt in the middle with a conical washer and nut.
11. Place the unassembled 5<sup>th</sup> wheel saddles/slider/goose into the already installed mounting rail. Position the second mounting rail with the saddles/slider/goose by inserting the tabs into the mounting rail and pushing the mounting rail tight towards the other mounting rail. Ensure that the mounting rail is centered between the weld seams on the length of the truck box floor. This will position the mounting rail in the correct location and ensure that the 5<sup>th</sup> wheel will have a snug fit to the truck. **NOTE:** If more than one hitch product will be used with the rails then both should be used at the same time to alien the second rail. This will ensure that one product does not compromise the fit of the other.
12. Repeat Steps 5, 7, 9 and 10.
13. Tighten the fasteners in the following sequence: 1) torque the mounting rails to the frame brackets, 2) torque the frame brackets to the truck frame. **Torque all 1/2" Gr5 hardware to 72 ft-lbs (98 N-m), 5/8" Gr5 hardware to 150 ft-lbs (204 N-m) and the 5/8" Gr8 hardware to 212 ft-lbs (287 N-m).**
14. **On 2005 and up Gas Engine Vehicles Only.** Use the factory flange nut that was removed in Step 2 to tighten the tube holder onto the L-bracket as shown in Figure 3c.
15. Reinstall spare tire.

# OPTION 1

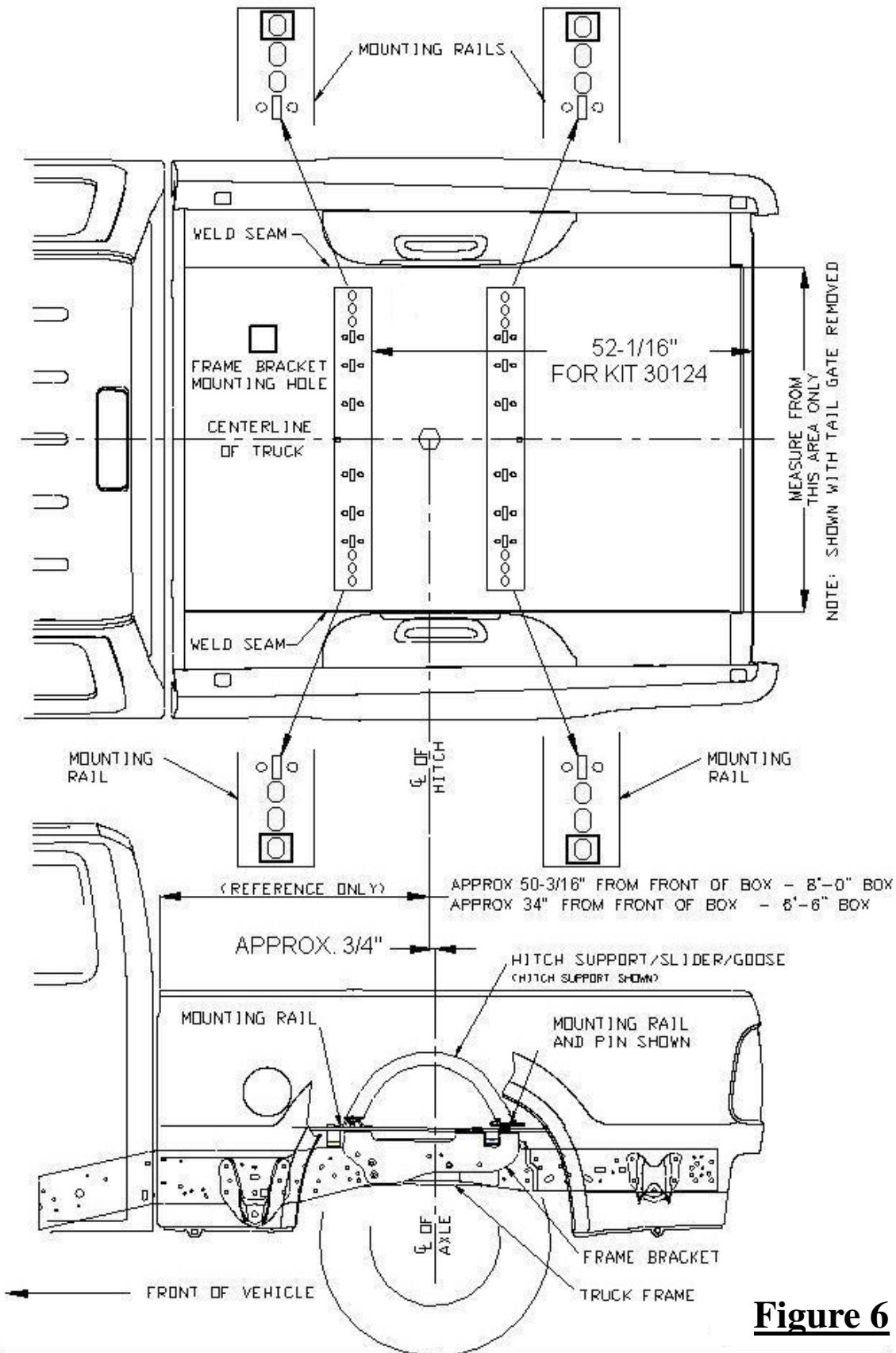
## DIMENSIONS SPECIFIC FOR RAIL KIT 58058



**Figure 5**

# OPTION 2

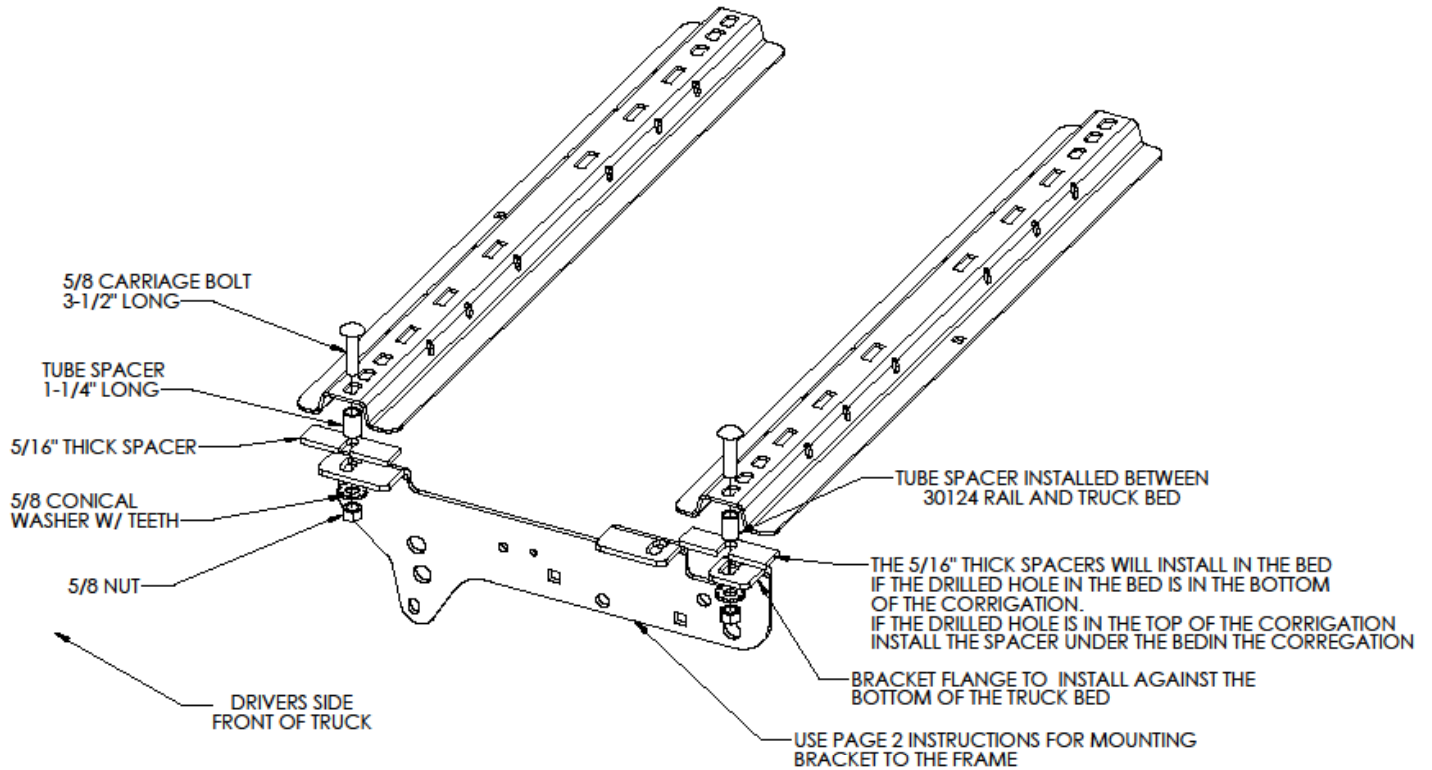
## DIMENSIONS SPECIFIC FOR RAIL KIT 30124



**Figure 6**

# INSTRUCTIONS WHEN USING THE 30124 RAIL KIT WITH FORD SUPER DUTY F-250, F-350, F-450

HARDWARE AND INSTALLATION IS THE SAME FOR BOTH DRIVERS SIDE AND PASSENGERS SIDE



**Figure 7**